

HELP! THE ONLY REASON I HAVE A KITCHEN IS THAT IT CAME WITH THE HOUSE.

THE INTELLIGENT HAVE PLANS BUT THE WISE HAVE DESIGN PRINCIPLES.

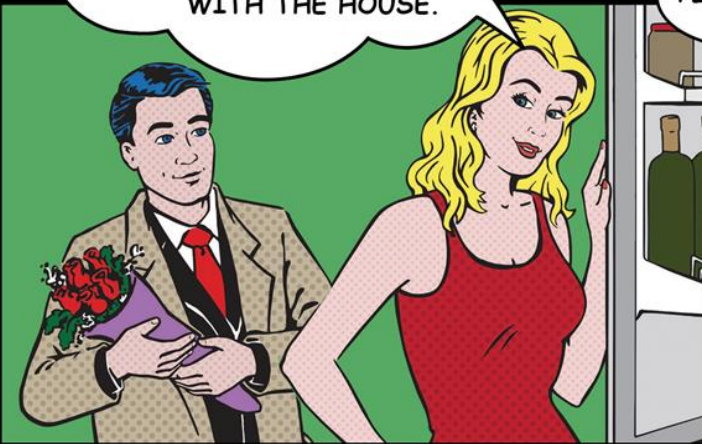

**SOPS60TC**  
24" Built-In Stainless Steel Oven

Porter & Charles  
2016 SPECIFICATION SHEET

# SOPS60TC

## 24" Built-In Stainless Steel Oven

*Let your kitchen be your showpiece! Designed to blend perfectly with all other appliances to enhance the appearance of any kitchen. A function to suit any cooking need thoughtfully designed to make cooking more enjoyable and efficient, and provide delectable results meal after meal.*



### OVEN ACCESSORIES

- Grill/roasting pan
- Baking sheet
- 2 chrome oven racks
- Telescopic rails
- Optional : LIE-7427640 - Silver cabinet base air ventilation grill

### ELECTRICAL REQUIREMENTS

- 208/240 Volt, 60Hz, 20 amp, 3220W
- Supplied with a 5ft long electrical cable and must be hard wired

### OVEN FEATURES

- 65 litre (2.29 cu. ft.) interior capacity
- 10 cooking functions including True Fan convection
- Retractable control knobs with touch control panel
- Double glazed down fold removable door with removable glass pane
- Fully automatic digital clock and timer
- Digital display with easy to use retractable control knobs
- Cooking Duration Feature and End Time cooking control
- Black enamel interior for easy cleaning
- 5 rack positions
- Child safety lock
- Bright interior light

### OVEN DIMENSIONS

D: 22<sup>3/8</sup>" • W: 23<sup>7/16</sup>" • H: 23<sup>1/4</sup>"

D: 569 mm • W: 595 mm • H: 591 mm

### CUT-OUT DIMENSIONS

D: min. 22<sup>1/4</sup>" x W: min.22<sup>1/16</sup>" x H: 23"

D: min 565mm x W: min.560mm x H: 585mm

# SPECIFICATIONS

## SOPS60TC

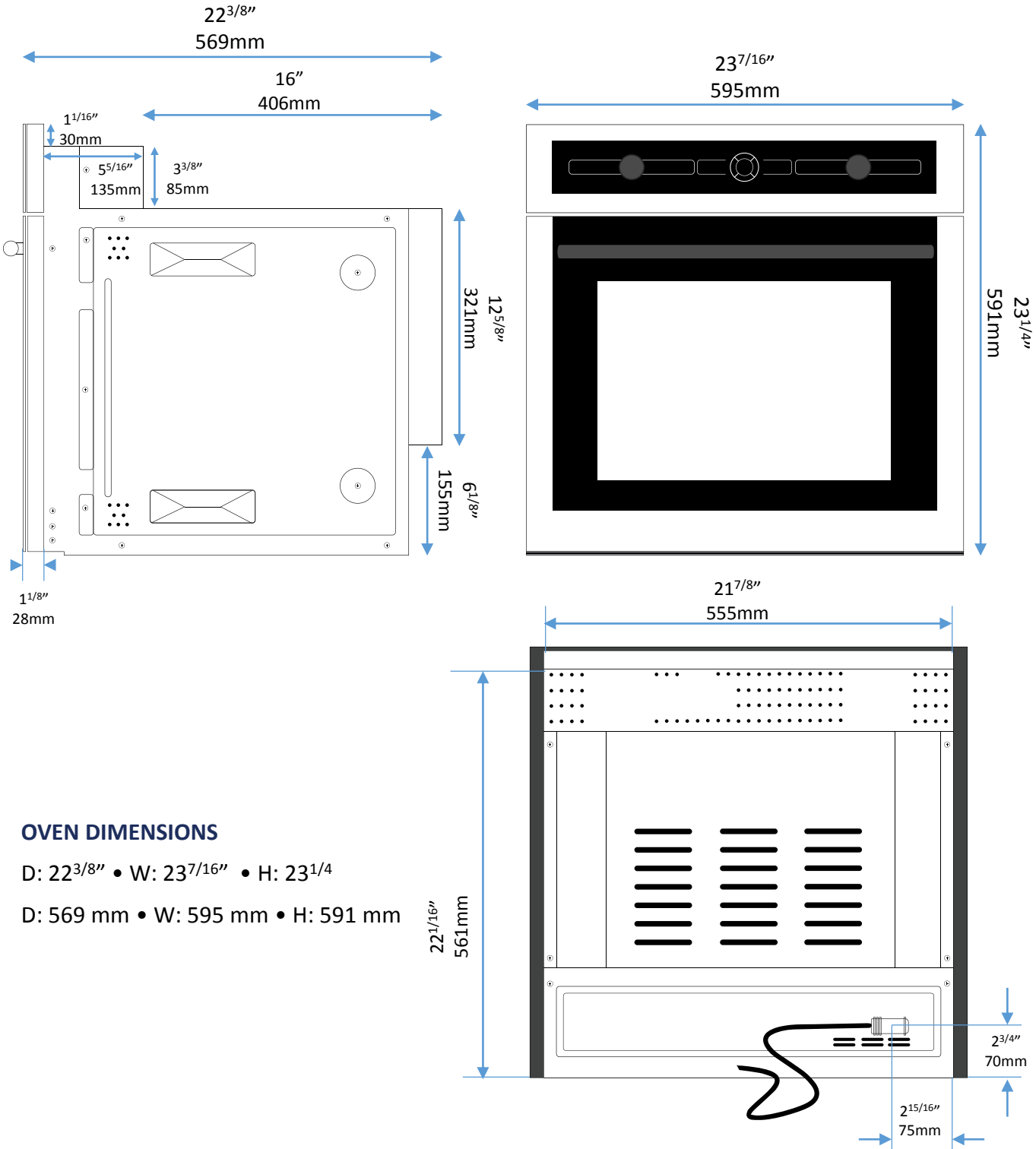

### OVEN DIMENSIONS

D:  $22\frac{3}{8}''$  • W:  $23\frac{7}{16}''$  • H:  $23\frac{1}{4}''$

D: 569 mm • W: 595 mm • H: 591 mm

# SPECIFICATIONS

## SOPS60TC

### OVEN DIMENSIONS

- D: 22<sup>3/8"</sup> x W: 23<sup>7/16"</sup> x H: 23<sup>1/4"</sup>
- D: 569 mm x W: 595 mm x H: 591 mm

### CUT-OUT DIMENSIONS

- D: min. 22<sup>1/4"</sup> x W: min. 22<sup>1/16"</sup> x H: 23"
- D: min 565mm x W: min. 560mm x H: 585mm

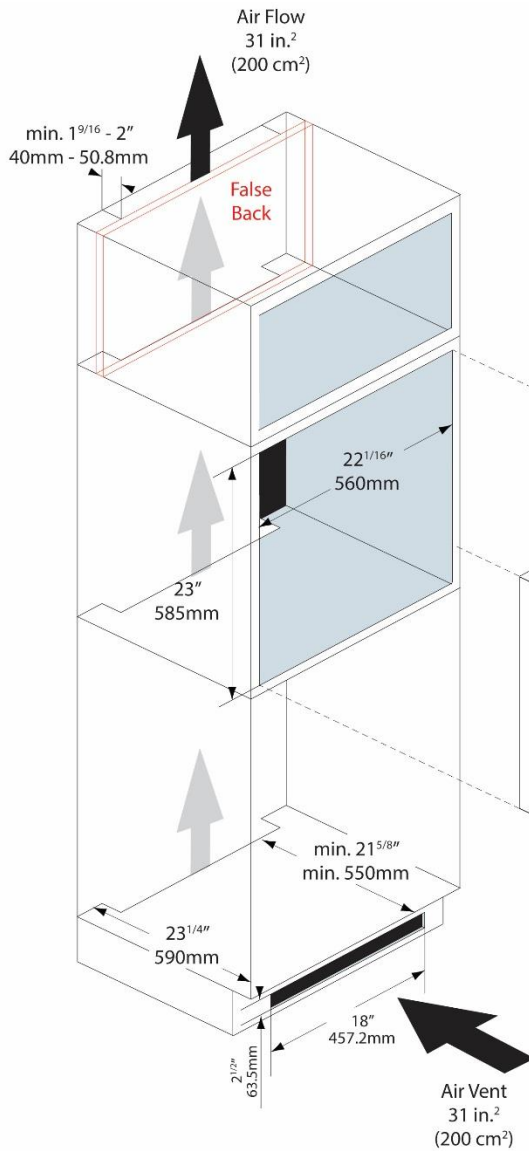

### ELECTRICAL REQUIREMENTS

- 220 / 240 Volt, 60Hz, 20 AMP, 3220W

### \*IMPORTANT\*

- PORTER&CHARLES ovens are supplied with a 5' long electrical cable and must be hard wired to the electrical supply
- PORTER&CHARLES ovens uses the following wires:  
RED & BLACK: Live Wires  
GREEN: Ground  
The Neutral (White) wire is not required for the electrical installation.

### FALSE BACKS

- Install false backs for storage spaces. This will prevent contents from falling through the vent space. In addition, warm air will not interfere with your stored contents

# SPECIFICATIONS

## SOPS60TC

### AIR FLOW REQUIREMENTS

- If the oven is being placed under the counter, there must be a minimum gap of  $1^{9/16}$ " (4cm) cut out of the shelf behind the oven to allow air to flow freely.
- If sufficient air flow is not provided, the life of the appliance will be shortened.
- Cut-out in the toe kick is recommended.
- Bottom vent grill (7427640) available.

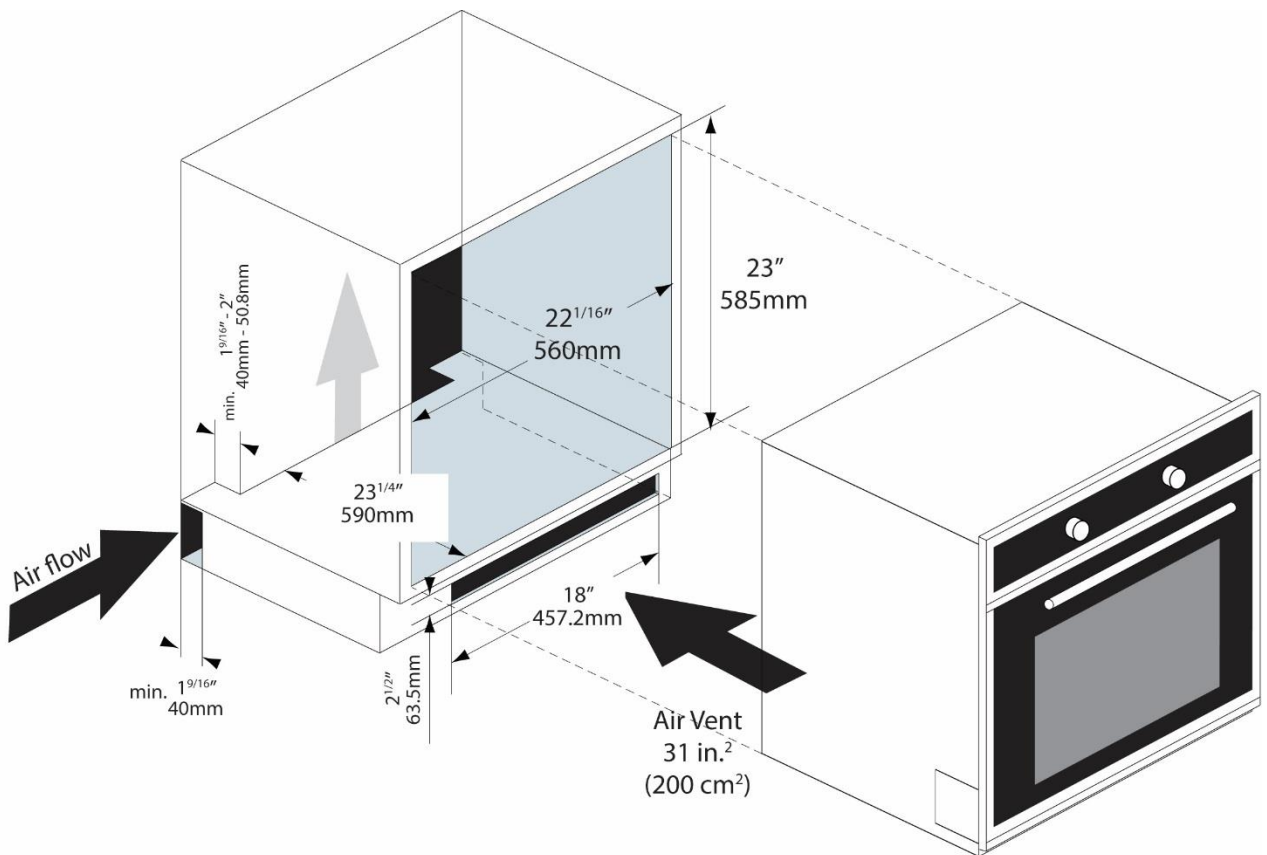



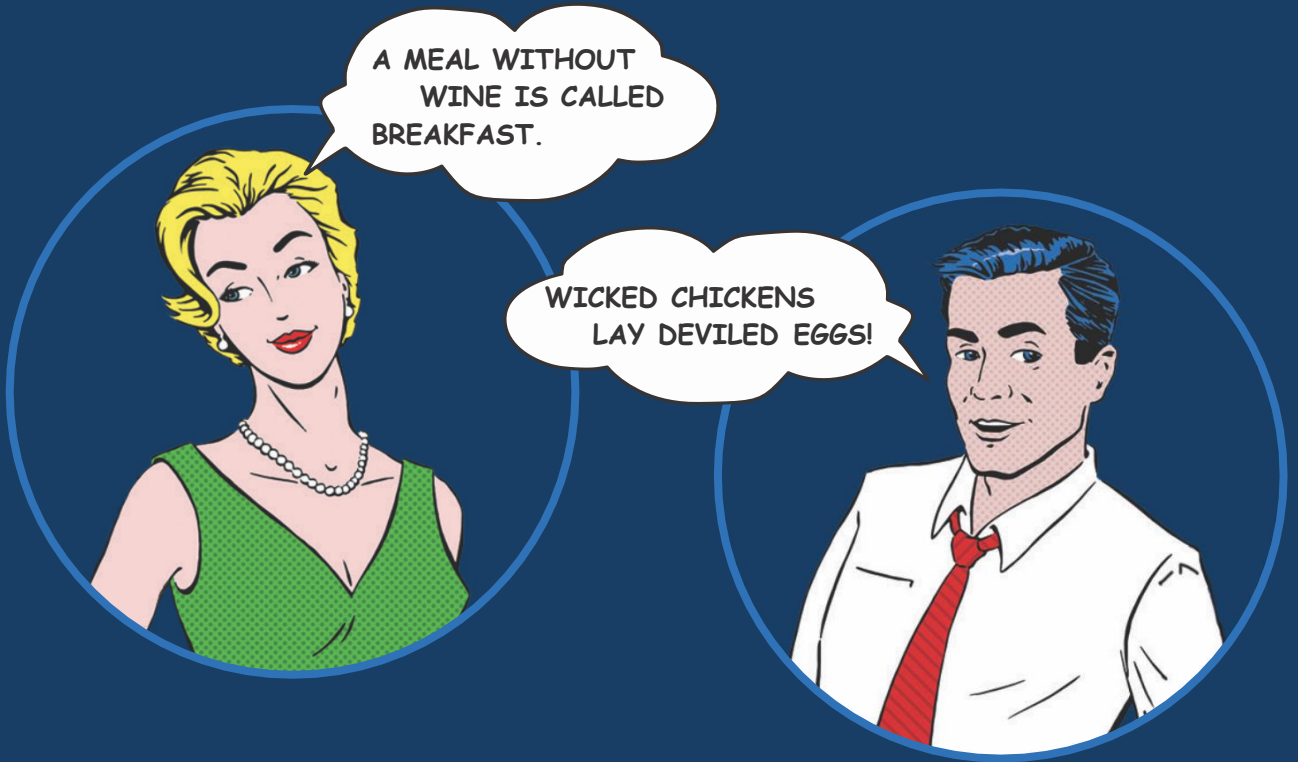

Porter & Charles Appliances are designed and manufactured to the highest standards. Each appliance is covered by a comprehensive 2-year parts and labour warranty.

Refer to product warranty policy for complete terms and conditions.

#### FOR PARTS AND SERVICE

Euro-Parts & Service

39822 Belgrave Road, Belgrave, ON. N0G 1E0  
1 800 678 8352 (Canada) • 1 800 561 4614 (U.S.)

[www.euro-parts.ca](http://www.euro-parts.ca) • [parts@euro-parts.ca](mailto:parts@euro-parts.ca) • [service@euro-parts.ca](mailto:service@euro-parts.ca)

Porter & Charles appliances are imported and distributed in North America by Euro-Line Appliances Inc. For more information, please visit one of our showrooms or [www.euro-line-appliances.com](http://www.euro-line-appliances.com) / [www.elawest.com](http://www.elawest.com)

#### EURO-LINE APPLIANCES INC.

871 Cranberry Court  
Oakville, ON L6L 6J7 Canada  
905 829 3980  
1 800 421 6332

[marketing@euro-line-appliances.com](mailto:marketing@euro-line-appliances.com)

#### EURO-LINE APPLIANCES WEST INC.

2912 West 4th Avenue  
Vancouver, BC V6K 1R2 Canada  
604 235 3980  
1 855 ELA WEST (352.9378)

[info@elawest.com](mailto:info@elawest.com)

