

HK854080XB
30" Ceramic Electric Cooktop

AEG

HK854080XB

30" Ceramic Electric Cooktop



COOKTOP FEATURES

- 30" (76cm) ceramic electric cooktop
- Stainless steel trim
- DirekTouch slide design touch controls
- 4 Hi-Lite zones with 14 power levels
- Automatic heat-up function
- LED display indicating power levels
- OptiFit cooktop with extendable cooking zone
- Adjustable timer – max 99 mins.
- Stop+Go function
- Child safety lock
- Residual heat indicator
- 2" deep for easy installation

COOKTOP PERFORMANCE

- 4 Hi-Lite zones with 9 power levels
- 1 x 14.5cm Single Zones: 1200 Watts
- 1 Expandable Double Zone:
- 1 x 12cm Single Zone: 700 Watts
 - 1 x 18cm Single Zone: 1700 Watts
- 1 Expandable Triple Zone:
- 1 x 14.5cm Single Zone: 1050 Watts
 - 1 x 21cm Expanded Zone: 1950Watts
 - 1 x 27cm Expanded Zone: 2700Watts
- 1 Expandable Casserole/Multi-purpose Zone:
- 1 x 17cm Single Zone: 1400 Watts

COOKTOP DIMENSIONS

- D: 20^{5/16}" x W: 30^{3/16}"
- D: 516mm x W: 766mm

CUT-OUT DIMENSIONS

- D: 19^{1/2}" x W: 29^{1/2}"
- D: 495mm x W: 750mm

ELECTRICAL REQUIREMENTS

- 208 / 230 Volt, 60Hz, 40 AMP, 7800W
- AEG Cooktops are supplied with a 5' long electrical cable and must be hard wired to the electrical supply.

Specifications

HK854080XB

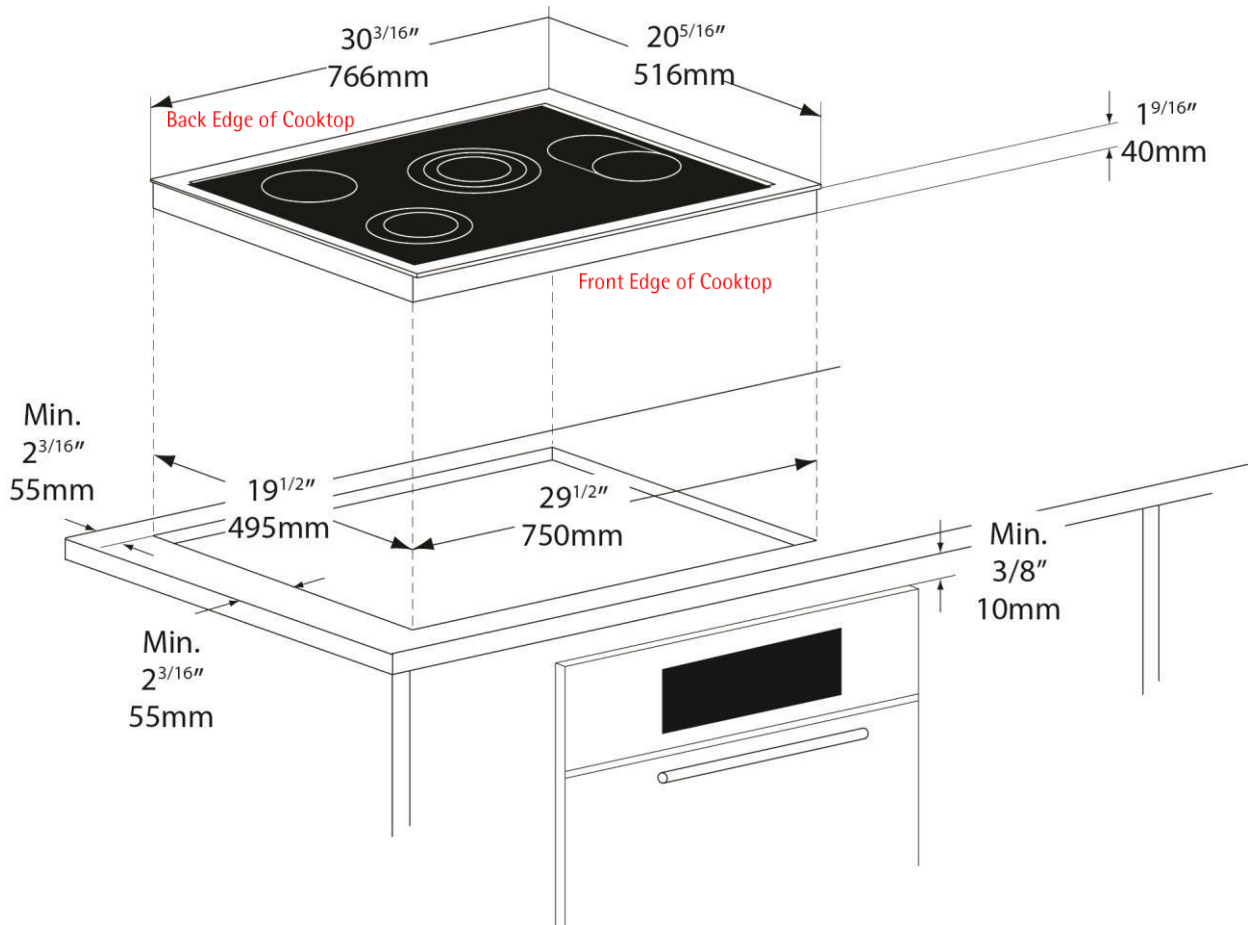

Specifications

HK854080XB

INSTALLING OVER BUILT-IN OVEN

- There must be a minimum of 20mm (13/16") of space left between the bottom of the cooktop and the oven to allow air to flow.
- There must be a minimum of 5mm (3/16") of space left between the counter top and the door panel of a built-in oven / drawer.
- If sufficient air flow is not provided, the life of the appliance will be shortened.

SIDE VIEW

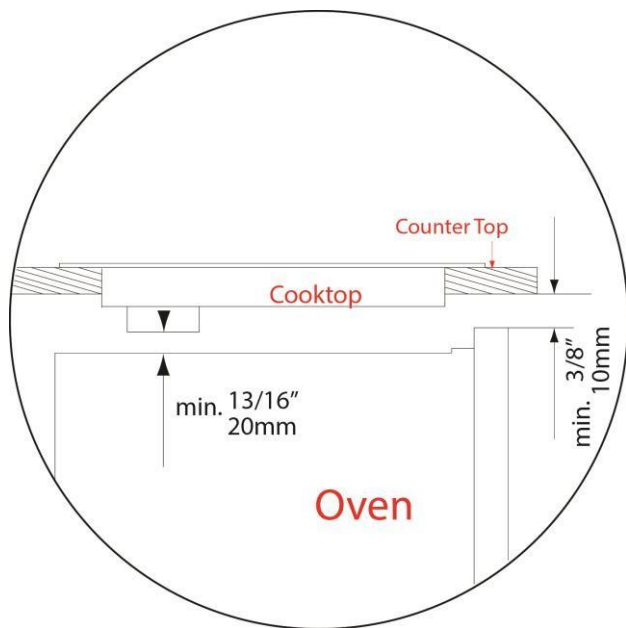

UNDERSIDE VIEW

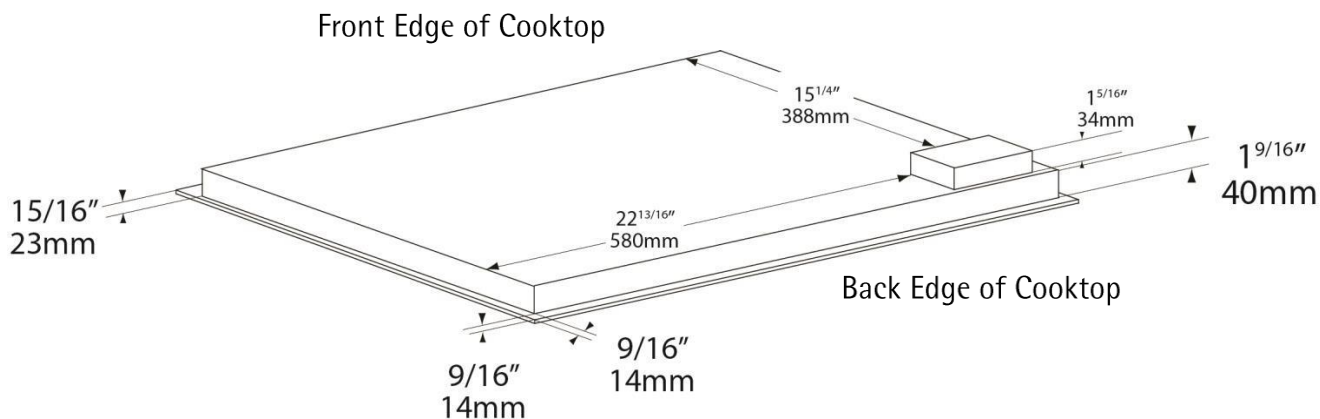

Specifications

HK854080XB

RECOMMENDED CABINET DESIGN

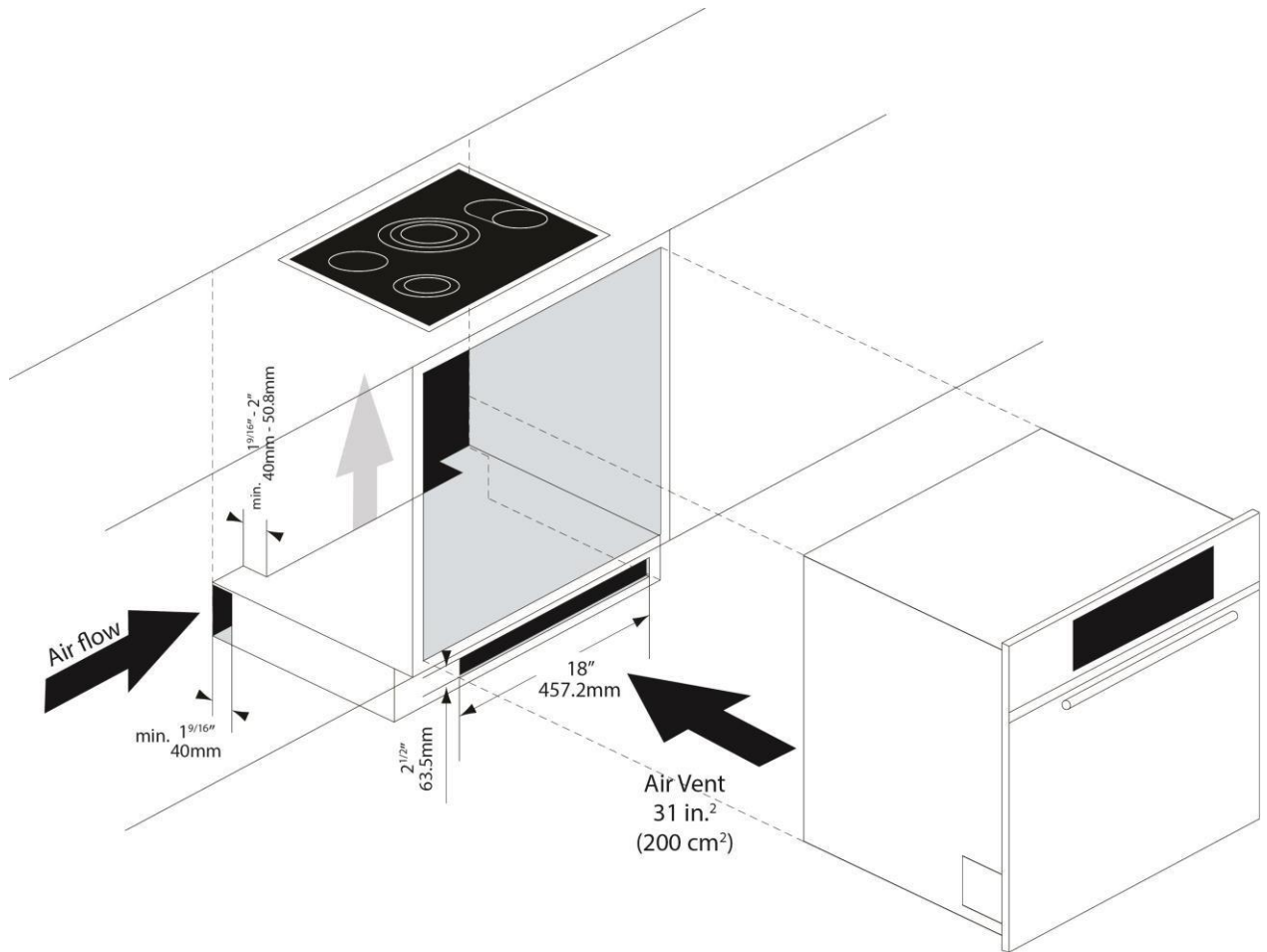

Specifications

HK854080XB

RECOMMENDED CABINET MINIMUM CLEARANCE

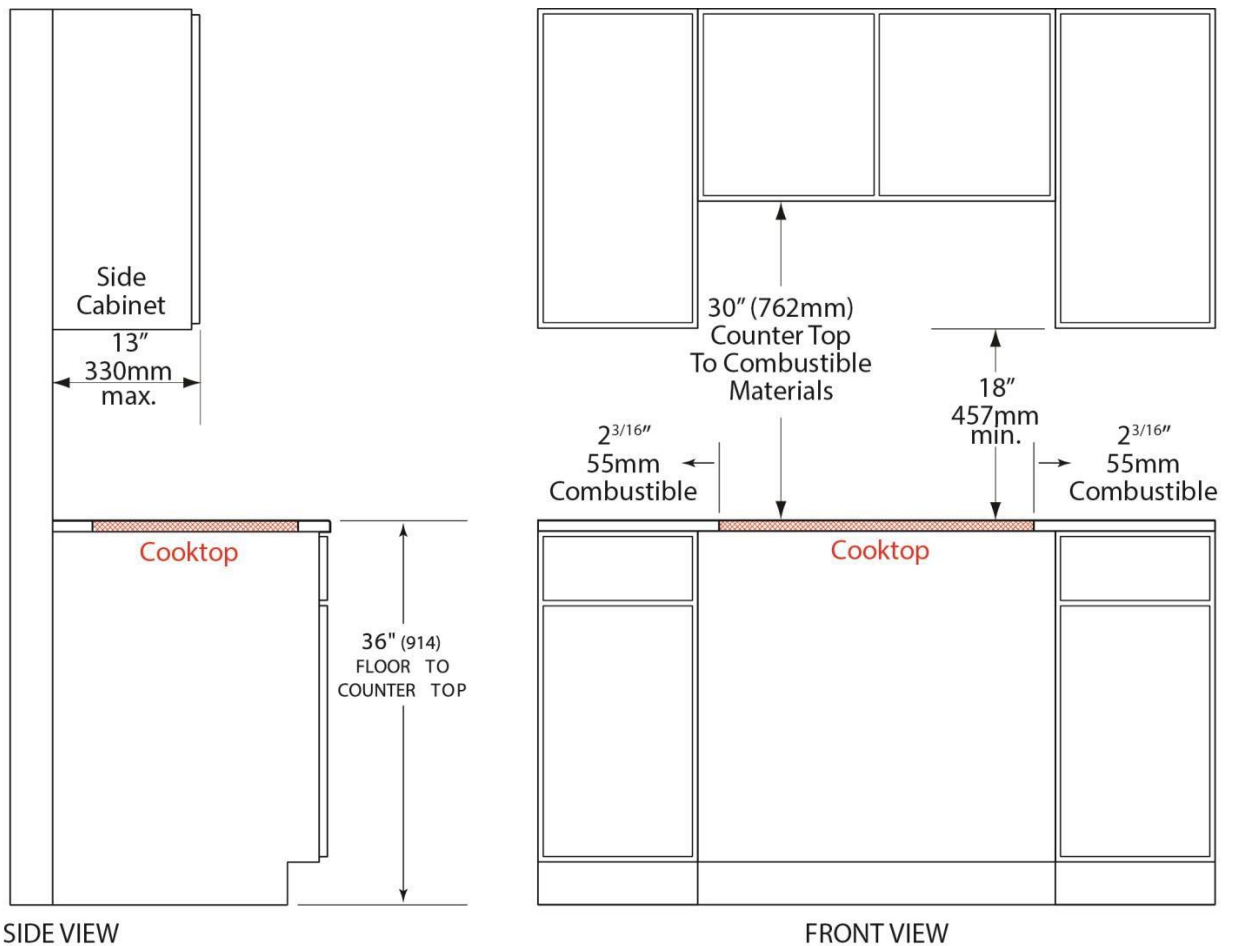

* Minimum clearance from cooktop cut out to combustible materials up to 18" (457mm) above countertop

AEG

AEG Appliances are designed and manufactured to the highest standards. Each appliance is covered by a comprehensive 2-year parts and labour warranty.

Refer to product warranty policy for complete terms and conditions.

FOR PARTS AND SERVICE

Euro-Parts & Service

39822 Belgrave Road, Belgrave, ON. N0G 1E0

1 800 678 8352 (Canada) • 1 800 561 4614 (U.S.)

www.euro-parts.ca • parts@euro-parts.ca • service@euro-parts.ca

AEG appliances are imported and distributed in North America by Euro-Line Appliances Inc. For more information, please visit one of our showrooms or

www.euro-line-appliances.com www.elawest.com

EURO-LINE APPLIANCES INC.

871 Cranberry Court
Oakville, ON L6L 6J7 Canada
905 829 3980
1 800 421 6332

marketing@euro-line-appliances.com

EURO-LINE APPLIANCES WEST INC.

2912 West 4th Avenue
Vancouver, BC V6K 1R2 Canada
604 235 3980
1 855 ELA WEST (352.9378)

info@elawest.com

